

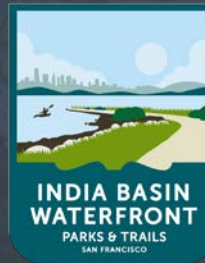

AUGUST 2021

Historic Preservation Commission – Shipwright’s Cottage Landmark #250 COA



INDIA BASIN WATERFRONT PARKS

RENOVATION PROJECT

2014

PROPERTY ACQUISITION



Connecting Community to the Waterfront & Saving a City Landmark

- Acquisition was driven by a community-led grassroots effort and connects two parks leading to 1.7 miles of contiguous accessible waterfront

PRIORITIES FOR PARK DEVELOPMENT

- ✓ Celebrate the history & cultural resources of India Basin & the Bayview Hunters Point neighborhood
- ✓ Create inspiring and amenity-rich waterfront parks that build community capacity and are reflective of the Bayview community
- ✓ Address decades of environmental contamination from boat building and repair activities
- ✓ Create a resilient, healthy and adaptive shoreline and community
- ✓ Prevent further displacement of the Black community living and working in Bayview-Hunters Point neighborhood



BUILD:

2014

PROPERTY ACQUISITION

2014-2015

WATERFRONT STUDY & NEEDS ASSESSMENT

2015-2016

ENGAGEMENT AND CONCEPT DESIGN COMPETITION

2017-2018

CONCEPT DESIGN, EIR CERTIFICATION, & GRANT APPLICATIONS/FUNDING

2019-2021

DETAILED DESIGN, MITIGATION MEASURE COMPLIANCE, EQUITABLE DEVELOPMENT PLANNING, CERTIFICATE OF APPROPRIATENESS

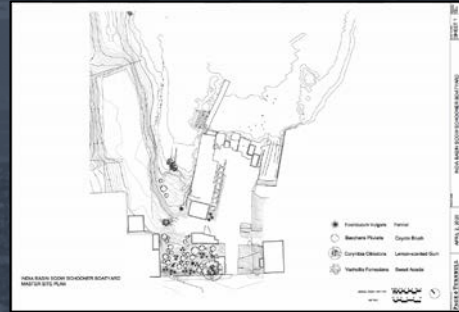

HABS/HALS - 2020

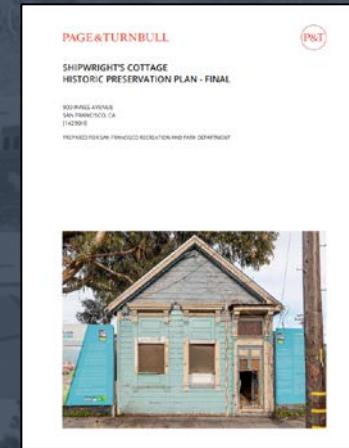

Historic Preservation Plan – 2020

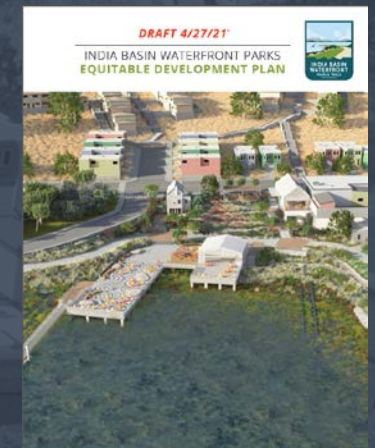

Equitable Development Plan - ongoing



Continued Community Engagement through EDP



Mitigation Program includes:

- HABS/HALS documentation
- Interpretive program
- Historic Preservation Plans to guide the protection and rehabilitation of the Shipwright's Cottage and landscape
- Salvage of significant historic materials
- Archeological Testing Plan & Archeological Monitoring Plan

SHIPWRIGHT'S COTTAGE (900 INNES)

Period of Significance: 1875 (Cottage), 1875-1936 (Scow Schooner Boatyard)



Non-Historic Alterations

SHIPWRIGHT'S COTTAGE (900 INNES)

Period of Significance: 1870-1930 per Landmark Designation*



Non-Historic Alterations



Insufficient Documentary Evidence

*Built in 1875, per same document

SHIPWRIGHT'S COTTAGE (900 INNES)

- Rehabilitate to serve as Welcome Center, gallery, and multi-purpose community space
- Highlight history & culture of Bayview



Historic, ca. 1970

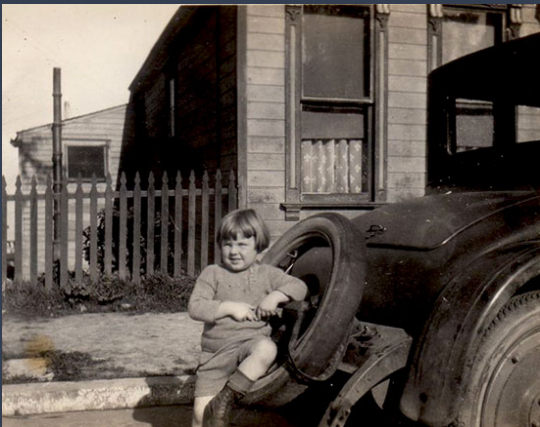

Historic, with original windows

“ It's unfortunate that others have been knocked down and it appears to be the only one left that has a link to the history of the boatyard. ”

Dean Anderson, Former Resident of 900 Innes
Landmark 900 Innes! Video, IBNA



Existing Conditions

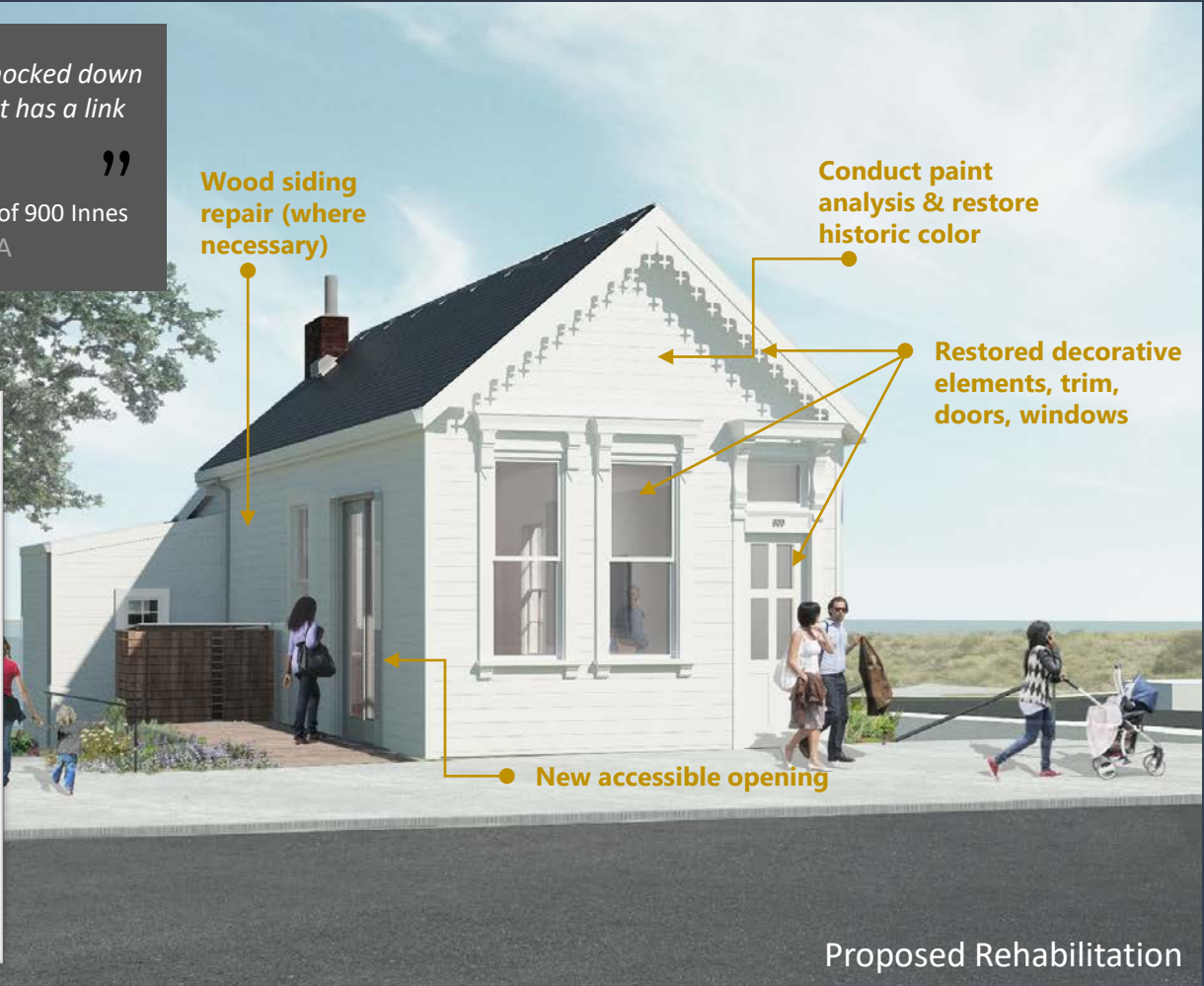

Proposed Rehabilitation

SHIPWRIGHT'S COTTAGE (900 INNES)



“ There is no place in San Francisco that honors shipwrights or boat builders....[W]ork is an important component of a heritage.... I am glad I was a shipwright. ”

Archie Green, Retired Shipwright
Landmark 900 Innes! Video, IBNA

SHIPWRIGHT'S COTTAGE INTERPRETIVE PROGRAM

IDEAS AND PRECEDENTS

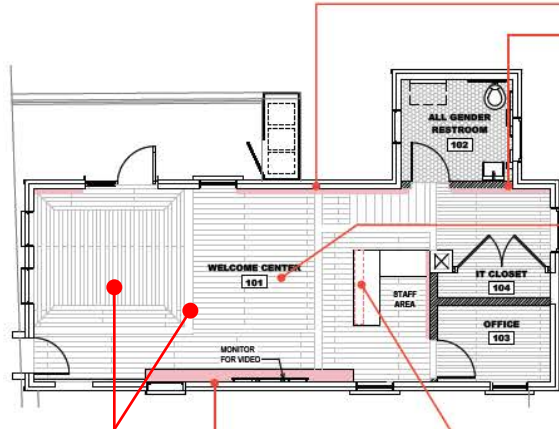

Reuse historic wood flooring, trim, and ceiling, and retain ghosting from former walls and historic stair

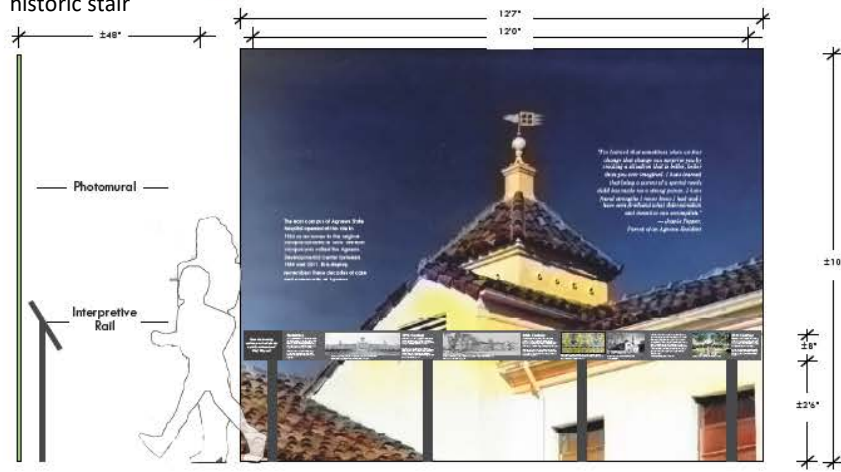

Large-scale Graphics and Interpretive Rail



Artifact Cases



Interactive Displays



Historically-Focused Retail Items



Wall Panels and Video/Digital Displays

INDIA BASIN INTERPRETIVE PROGRAM



Interpretive Signage Plan

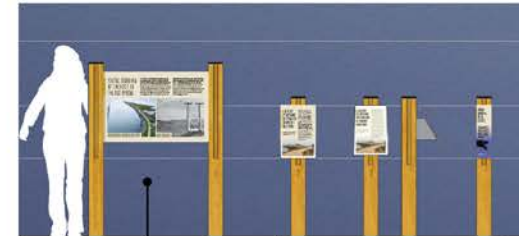

● Primary Interpretive

■ Secondary Interpretive



— Integrated Interpretive Panels

Phase 1 - 900Innes

INDIA BASIN INTERPRETIVE PROGRAM



Overall Signage Plan

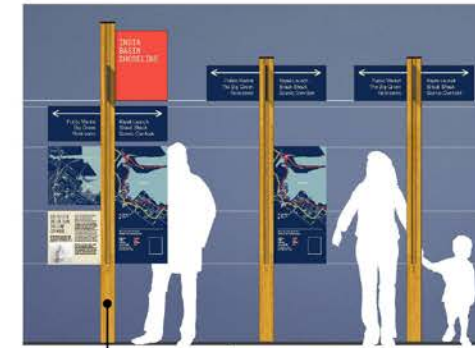

● Primary Wayfinding
■ Secondary Wayfinding

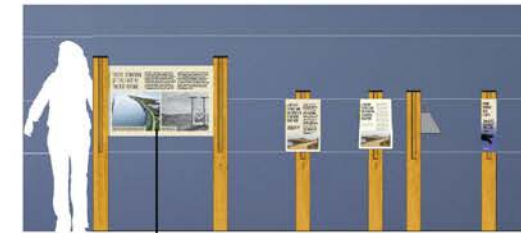

● Primary Interpretive
■ Secondary Interpretive



— Integrated Interpretive Panels

Phase 1 - 900Innes

THANK YOU



900 INNES BOATYARD PARK

- Fill critical gap in **San Francisco Bay Trail**
- Increase recreational opportunities and create new spaces to **gather and play**
- Improve shoreline access and resiliency through the rebuild of public piers and docks
- **Restore degraded habitat** by removing contaminated soil/sediments, improving intertidal habitat conditions
- **Build capacity** through workforce, jobs, community learning hubs, and rec programming
- Maintain placemaking through **arts, history and culture**



INDIA BASIN SHORELINE PARK



- Expand recreational opportunities (great lawn, cookout/barbecue areas, amphitheater)
- Provide waterfront rec and programming and Bay access through boathouse, boat launch, gravel shore, and outdoor classroom
- Significantly increase wetlands habitat and upland planting
- Enhance active play opportunities (new playground, basketball courts, fitness station)